

### Component Location & Identification Diagram

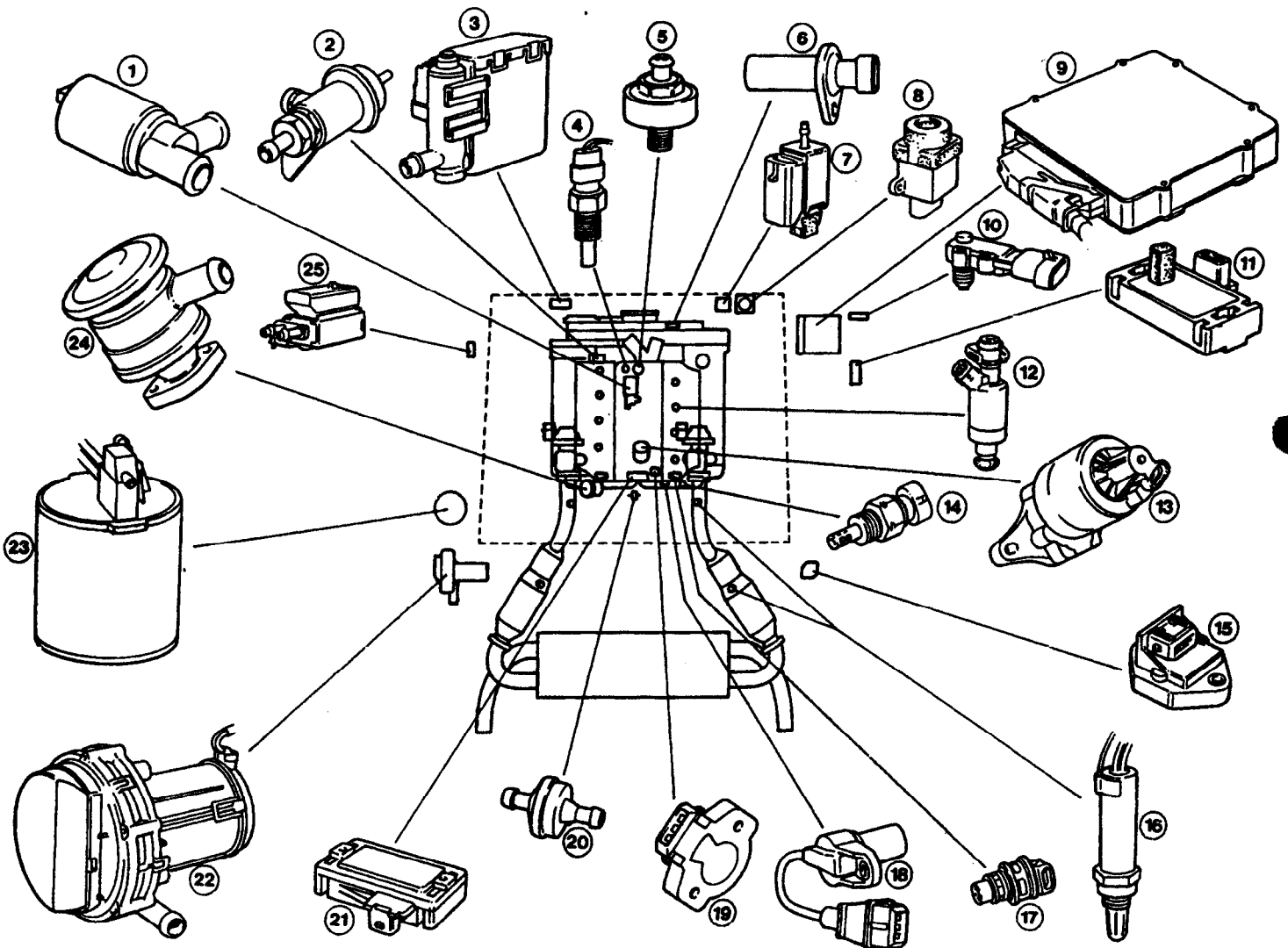

emiss

### Key to Component Location & Identification Diagram

- |  |  |
|--|--|
| 1. Idle Air Control (IAC) valve.           | 14. Intake Air Temperature (IAT) sensor.     |
| 2. Fuel Pressure Regulator Valve (PRV).    | 15. Rough road sensor.                       |
| 3. Charcoal canister vent close valve.     | 16. Oxygen (O <sub>2</sub> ) sensor.         |
| 4. Coolant Temperature Sensor (CTS).       | 17. Plenum (secondary) injectors.            |
| 5. Knock sensor.                           | 18. Camshaft sensor.                         |
| 6. Crankshaft sensor.                      | 19. Throttle Position (TP) sensor.           |
| 7. Wastegate solenoid valve.               | 20. Non-return valve (breather).             |
| 8. Inertia switch.                         | 21. Manifold Absolute Pressure (MAP) sensor. |
| 9. Electronic Control Module (ECM).        | 22. Air pump.                                |
| 10. Fuel tank pressure sensor.             | 23. Charcoal canister.                       |
| 11. Barometric (BARO) sensor.              | 24. Air injection (AIR) control valve.       |
| 12. Port fuel injector.                    | 25. Air injection (AIR) solenoid valve.      |
| 13. Exhaust Gas Recirculation (EGR) valve. |  |